

Artwork Information

Project Title: Doral Iconic Sculpture

Overview:

We propose the creation and installation of a custom-designed metal sculpture featuring the word "DORAL," with a heart symbol creatively integrated into the design to reflect the city’s vibrant and welcoming spirit. This artwork is intended to serve as a bold, iconic photo opportunity and community landmark.

Sculpture Description:

- **Material:** Powder-coated marine-grade aluminum
- **Design:** The word “DORAL” in bold block letters with a heart shape replacing the “O”
- **Finish:** Weather-resistant and graffiti-resistant coating
- **Size:** 11’11” Wide x 16” Width x 56” Tall
- **Mounting:** Two metal base supports welded to the structure for secure bolting onto concrete pads

Installation & Site Requirements:

- The sculpture includes two integrated 16" x 16" mounting plates.
- It is designed to be anchored to concrete pads, which should each measure approximately **24" x 24"** and be capable of supporting **a minimum of 500 lbs.**
- The sculpture will be delivered ready for mounting. Installation includes secure bolting to the pads and final inspection.
- **Note:** Concrete pads are not included in this proposal and are to be provided or arranged by the City of Doral.

Cost Breakdown:

Item	Cost
▪ Fabrication of DORAL sculpture	\$38,000
▪ Powder coating and finish	\$3,500
▪ Delivery & transportation	\$2,500
▪ Installation (excluding concrete pads)	\$5,500
▪ <u>Engineering for Permitting</u>	Included
Total Proposed Price	\$49,500

Timeline:

- Fabrication: 6–8 weeks
- Installation: 1–2 days after delivery and pad readiness

Additional Notes:

This sculpture is designed to be a community centerpiece, encouraging civic pride and social media engagement. It aligns with Doral’s commitment to public art, beautification, and cultural expression.

We are confident this piece will enhance the city’s landscape and provide residents and visitors with a lasting symbol of Doral's character.

Copyright Notice: The design and imagery of the "DORAL" sculpture remain the intellectual property of Tube Dude. By purchasing physical artwork, the City of Doral does not obtain rights to reproduce, modify, or license the design without written permission.

Proposed Art Renderings:

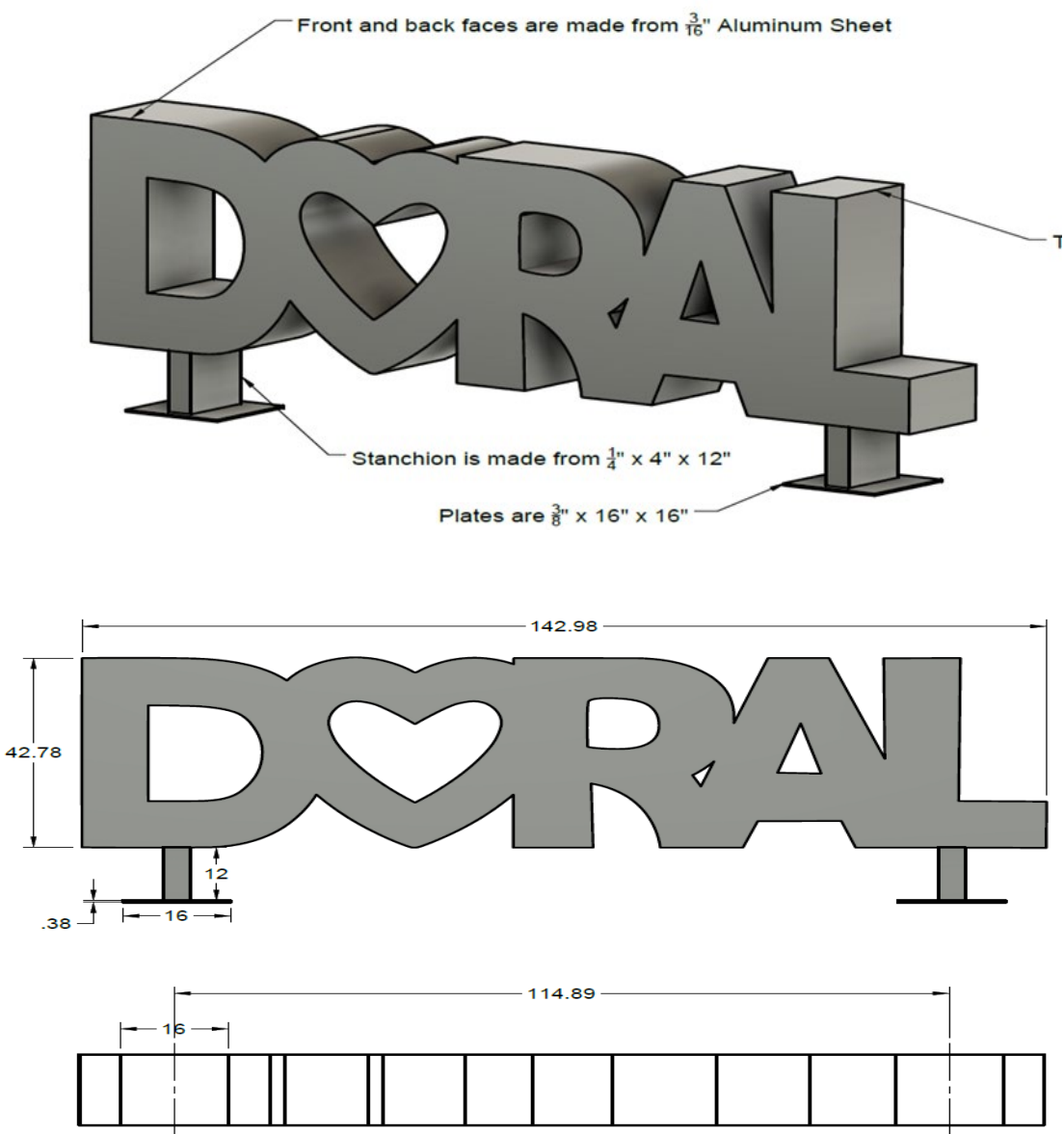

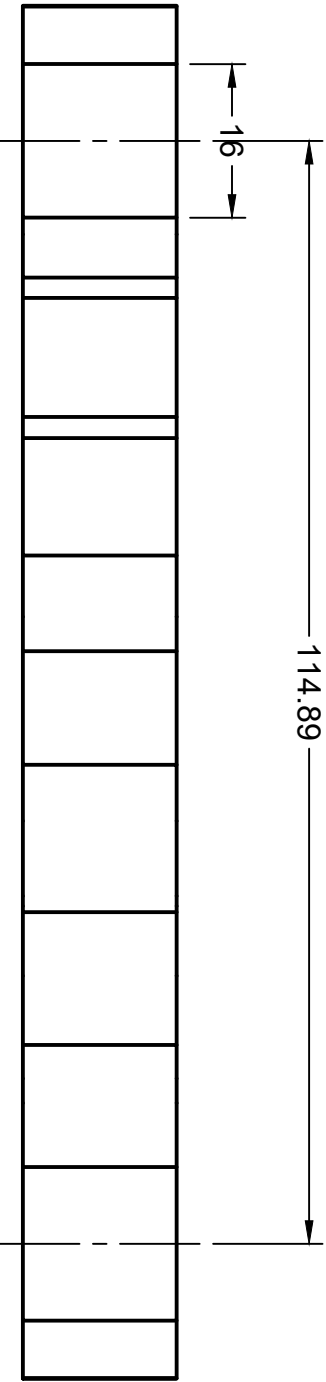
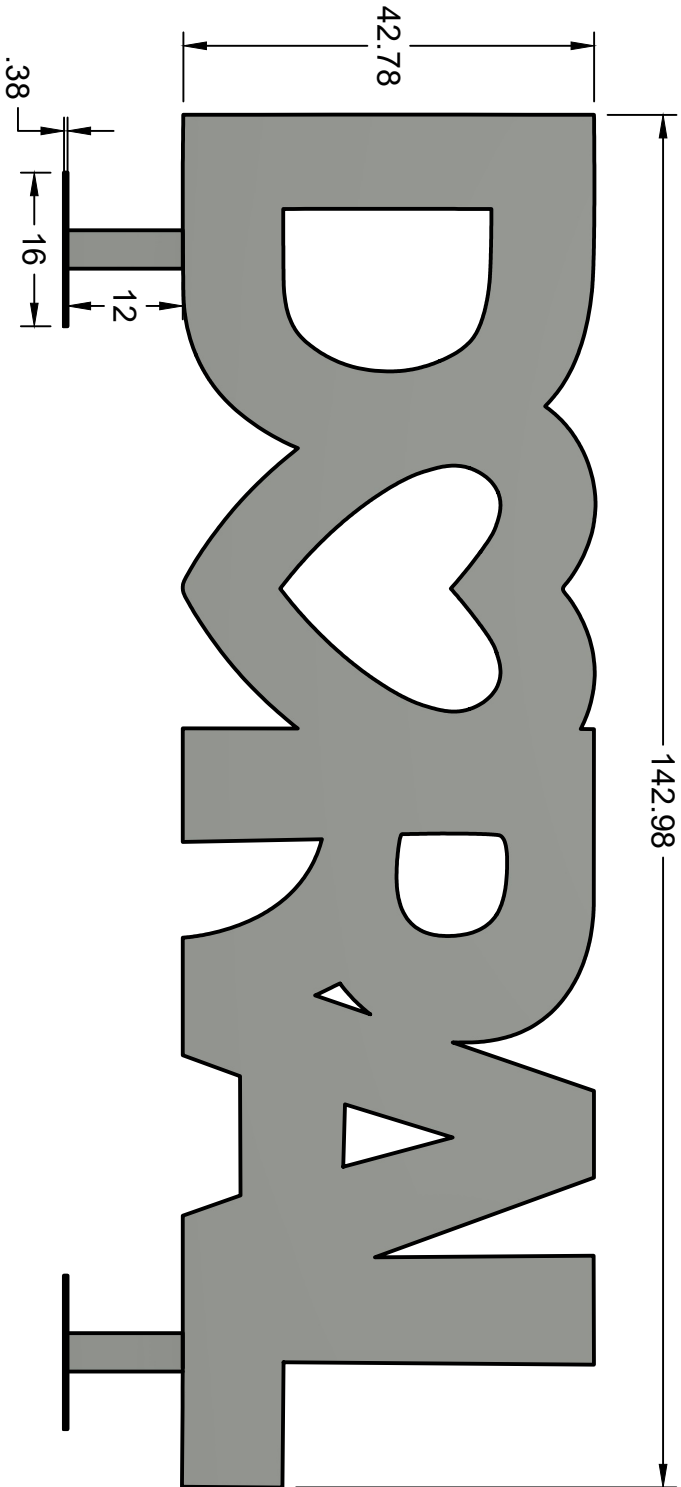
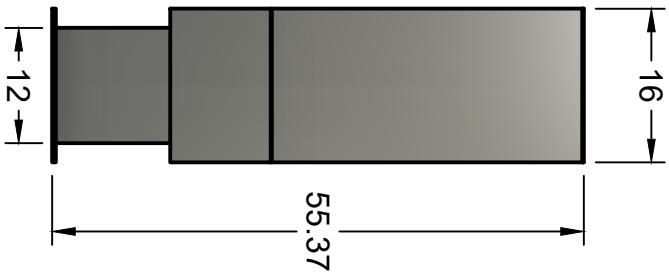

Front and back faces are made from $\frac{3}{16}$ " Aluminum Sheet

The sides connecting faces are made from $\frac{1}{8}$ " Aluminum Sheet

Stanchion is made from $\frac{1}{4}$ " x 4" x 12"

Plates are $\frac{3}{8}$ " x 16" x 16"

PROJECT			Tube Dude		
			Doral Project		
APPROVED			SIZE	CODE	DWG NO
CHECKED			B		
DRAWN	Brandon Caton	5/2/2025	SCALE 1:20	WEIGHT ~350 lbs	SHEET 1/1

Location Plan



Artist Information

Name: Scott Gerber

Known For: Creator of the *Tube Dude* public art sculptures

Location: Sarasota, Florida

Profession: Artist, entrepreneur, and metal fabricator



Background:

Scott Gerber is an American artist and fabricator best known for creating the "Tube Dude" series—whimsical, human-like sculptures made from colorful bent aluminum tubing. Originally a successful metal fabrication entrepreneur in Sarasota, Florida, Gerber turned to public art during the economic downturn of the late 2000s after his fabrication business was impacted.

In 2010, he installed the first Tube Dude figure in front of his own business as a creative and humorous way to attract attention. The eye-catching design quickly gained local and national interest, sparking a movement that led to dozens of Tube Dudes being installed in locations across the U.S. and abroad.

Artistic Style and Themes:

- The Tube Dudes are typically bright, playful figures posed in everyday scenarios—fishing, waving, riding bikes, reading, etc.
- Gerber uses marine-grade aluminum, powder-coated in vibrant colors, making the sculptures durable and weather-resistant.
- The style blends urban placemaking, humor, and accessibility, helping transform streetscapes into interactive, welcoming environments.

Civic and Cultural Impact:

- Tube Dude installations have become symbols of community engagement and positivity.
- Gerber's work is often used by municipalities and businesses to promote public interaction, wayfinding, or branding.
- His sculptures are often installed as part of public-private partnerships, particularly in areas seeking pedestrian activation or commercial revitalization.

Artist's Previous Works:

