

Downtown Doral Playground



Downtown Doral Playground
Doral, FL



Representing:



Project No:
PM24392D



Downtown Doral Playground
Doral, FL



Representing:



Project No:
PM24392D



Downtown Doral Playground
Doral, FL

Representing:



Project No:
PM24392D



Downtown Doral Playground
Doral, FL



Representing:



Project No:
PM24392D



Downtown Doral Playground
Doral, FL



Representing:



Project No:
PM24392D



Downtown Doral Playground
Doral, FL



Representing:



Project No:
PM24392D



Downtown Doral Playground
Doral, FL



Representing:



Project No:
PM24392D



Downtown Doral Playground
Doral, FL



Representing:



Project No:
PM24392D



Downtown Doral Playground
Doral, FL



Representing:



Project No:
PM24392D



Downtown Doral Playground
Doral, FL



Representing:



Project No:
PM24392D



Downtown Doral Playground
Doral, FL



Representing:



Project No:
PM24392D



Downtown Doral Playground
Doral, FL



Representing:



Project No:
PM24392D



Downtown Doral Playground
Doral, FL



Representing:



Project No:
PM24392D



Downtown Doral Playground
Doral, FL



Representing:



Project No:
PM24392D



Downtown Doral Playground
Doral, FL



Representing:



Project No:
PM24392D



Downtown Doral Playground
Doral, FL



Representing:



Project No:
PM24392D



Downtown Doral Playground
Doral, FL

Representing:



Project No:
PM24392D



Downtown Doral Playground
Doral, FL



Representing:



Project No:
PM24392D

Playworld Colors

Main Structure: Posts - Light Gray Components -
Light Gray Components 2 - Chartreuse, Teal
(Twist-N-Twirl) Rotoplastics - Teal, Chartreuse
Sheet Plastics - Lime 2-Color Sheet Plastics -
Beige/Gray
Decks - Gray

Rope - Black

Shades:

Posts - Forest Green (Existing color)

Fabric - Laguna Blue

Garden Sensory Wall:

Components - Light Gray

2-Color Sheet Plastics - Lime/Sand

Swings:

Posts - Light Gray

Top Rail - Light Gray

Swing Along Seat - Chartreuse

Ada Seat - Teal

Shade - Laguna Blue

Chimes, Vibes & 5 - Congas:

Posts & Components - Chartreuse

Downtown Doral Playground
Doral, FL



Representing:



Project No:
PM24392D

Playworld Colors

Playcube Retreat:

Components 1 - Light Gray

Components 2 - Chartreuse

Components 3 - Chartreuse

Rotoplastics - Teal

Cozy Cocoon:

Posts & Components - Light gray

Rotoplastics - Teal / Green

Berliner Colors:

Cosmo Base:

Clamps & Balls - RAL 5021 Water Blue

Rope - Lime

Downtown Doral Playground
Doral, FL



Representing:



Project No:
PM24392D



Playmore
Recreational Products
& Services
6300 Metro Plantation Road
Fort Myers, FL 33966
(888)886-3757

EQUIPMENT SIZE:
5-12: 40'8" x 39'5" x 12'3"
2-5: 22'5" x 22' x 10'6"

USE ZONE:
169'8" x 60'9"

AREA: 7,236 SqFt. PERIMETER: 407'5"

FALL HEIGHT:
8 Ft.

USER CAPACITY: 131+ AGE GROUP: 2-12

✓ ASTM F1487-25

PROJECT NO: PM24392C SCALE: 1/16"=1'-0"

DRAWN BY: REA DATE: 31-MARCH-2026 Paper Size **B**

ADA SCHEDULE	Total Elevated Play Activities: 0		
	Total Ground-Level Play Activities: 10		
	Accessible Elevated Activities	Accessible Ground-Level Activities	Accessible Ground-Level Play Types
Required	0	0	0
Provide	0	10	3

Provide

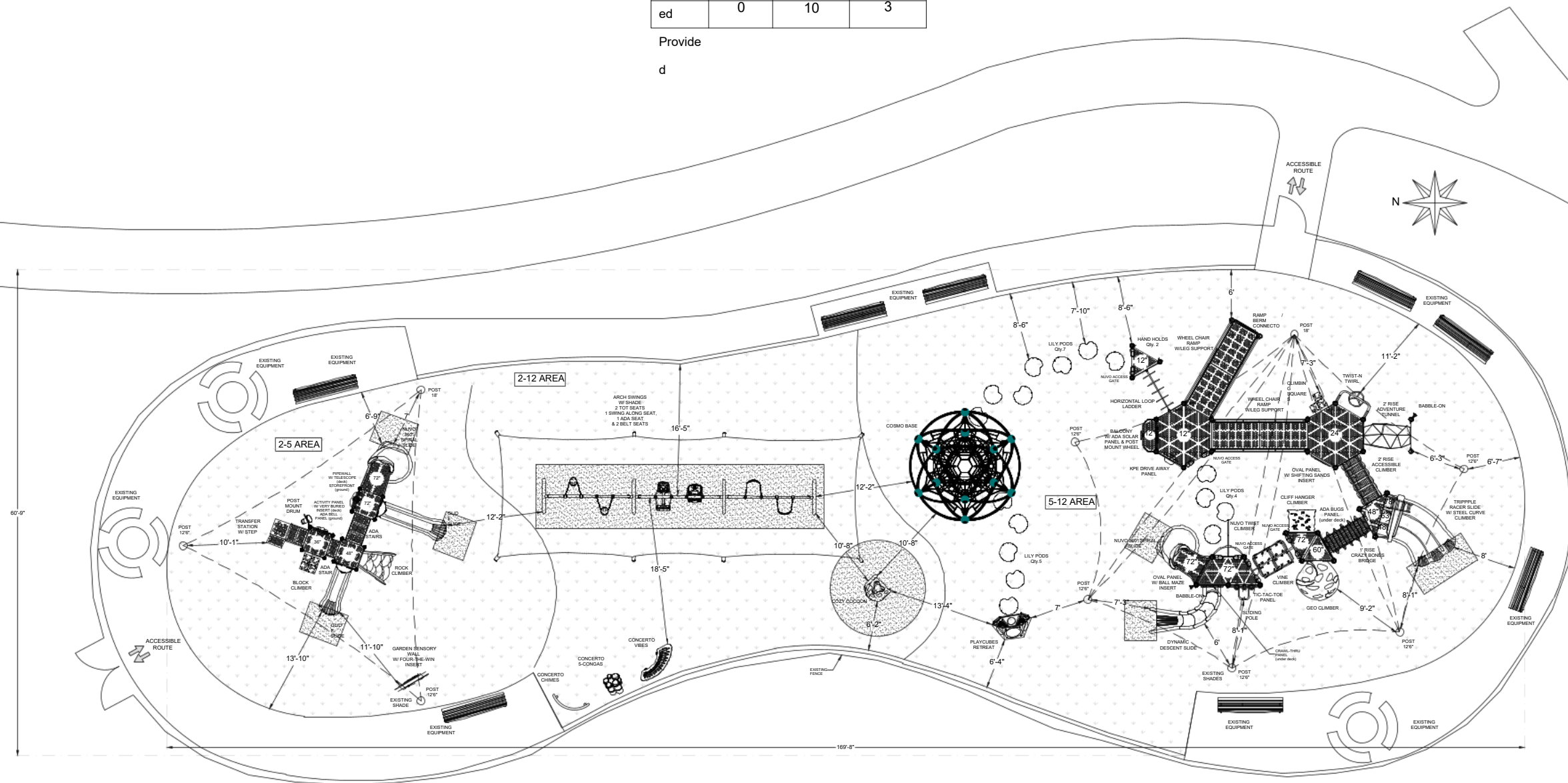

NOTE:
ALL EQUIPMENT MUST BE A MINIMUM OF 6" (153mm) FROM ANY TREE BASE. TREE BRANCHES MUST BE TRIMMED AS REQUIRED BY APPLICABLE GUIDELINES.

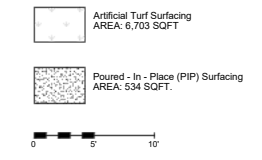

ADA SCHEDULE	Total Elevated Play Activities: 7		
	Total Ground-Level Play Activities: 4		
	Accessible Elevated Activities	Accessible Ground-Level Activities	Accessible Ground-Level Play Types
Required	4	2	2
Provide	7	4	3

Provide

ADA SCHEDULE	Total Elevated Play Activities: 19		
	Total Ground-Level Play Activities: 21		
	Accessible Elevated Activities	Accessible Ground-Level Activities	Accessible Ground-Level Play Types
Required	10	6	3
Provide	13	21	6

Provide

Downtown Doral Playground

Design Number: PM24392C - Bill Of Material

Ref. No.	Part No. Description	Quantity
Posts		
	1ZZCH0018 3.5in OD x 124in STEEL POST W/RIVETED CAP	4
	2ZZCH0028 3.5in OD x 136in STEEL POST W/ RIVETED CAP	4
	3ZZCH0048 3.5in OD x 160in STEEL POST W/ RIVETED CAP	4
	4ZZPM0006 5in OD X 96in STEEL POST W/ RIVETED CAP	7
	5ZZPM0008 5in OD X 108in STEEL POST W/ RIVETED CAP	4
	6ZZPM0016 5in OD X 120in STEEL POST W/ RIVETED CAP	2
	7ZZPM0026 5in OD X 132in STEEL POST W/ RIVETED CAP	7
	8ZZPM0036 5in OD X 144in STEEL POST W/ RIVETED CAP	1
	9ZZPM0046 5in OD X 156in STEEL POST W/ RIVETED CAP	3
	10ZZPM0056 5in OD X 168in STEEL POST W/ RIVETED CAP	2
	11ZZPM0066 5in OD X 180in STEEL POST W/ RIVETED CAP	5
Decks & Kick Plates		
	12ZZCH0616 SQUARE COATED DECK ASSEMBLY	3
	13ZZPM0617 TRIANGULAR COATED DECK ASSEMBLY	3
	14ZZPM0618 1/2 HEX COATED DECK ASSEMBLY	1
	15ZZPM0619 HEX COATED DECK ASSEMBLY	2
	16ZZPM0639 45 DEGREE TRI COATED DECK ASSEMBLY	1
	17ZZPM2530 12in DECK TO DECK KICK PLATE	1
ADA Items		
	18ZZCH2006 TRANSFER STATION (36in DECK)	1
	19ZZPM7537 GROUND TO DECK WHEELCHAIR RAMP W/ GUARDRAILS (12in RISE)	1
	20ZZPM7539 DECK TO DECK WHEELCHAIR RAMP W/ GUARDRAILS (12in RISE)	1
	21ZZPM8230 DECK TO DECK ACCESSIBLE CLIMBER (24in RISE)	1
	22 ZZUN2019 APPROACH STEP FOR TRANSFER STATION	1
	23ZZUN7369 RAMP TO BERM CONNECTOR	1
	24ZZUN9390 6in WHEELCHAIR RAMP CENTER SUPPORT	1
	25ZZUN9400 18in WHEELCHAIR RAMP CENTER SUPPORT	1
Slides		
	26 ZZCH2696 GLIDE SLIDE (72in DECK)	1
	27 ZZCH3126 GLIDE SLIDE (48in DECK)	1
	28 ZZCH3537 SLIDE- NUVO 360 SPIRAL SLIDE	1
	29ZZPM1374 TRIPPLE RACER SLIDE	1
	30ZZPM3421 DYNAMIC DESCENT SLIDE - ENTRANCE & EXIT	1
	31ZZPM3537 SLIDE- NUVO 360 SPIRAL SLIDE	1
	32ZZPM8090 SLIDING POLE (72in DECK)	1
	33ZZUN3402 DYNAMIC DESCENT SLIDE - RIGHT TURN SECTION	4
	34ZZUN3412 DYNAMIC DESCENT SUPPORT LEG - 3ft - 6in	1
Activity Panels		
	35ZZCH4357 PIPEWALL WITH LOWER TELESCOPE	1
	36ZZCH4646 STORE FRONT PANEL	1
	37ZZCH4671 CH PANEL FRAME- DECK LEVEL	1
	38ZZPM4350 TIC-TAC-TOE ACTIVITY WALL	1
	39 ZZPM4356 BALCONY	1



Downtown Doral Playground

Design Number: PM24392C - Bill Of Material

Ref. No.	Part No.	Description	Quantity
	40ZZPM4407	ACCESSIBLE SOLAR SYSTEM PANEL	1
	41ZZPM4408	ACCESSIBLE BUGS PANEL	1
	42ZZPM4488	DRIVE AWAY PANEL (DECK MOUNT)	1
	43ZZPM4807	OVAL INSERT PANEL (DECK MOUNT)	1
	44ZZPM4808	OVAL INSERT PANEL (GROUND LEVEL)	1
	45ZZUN4300	STEERING WHEEL (PIPE WALL MOUNT)	1
	46ZZUN4676	FOUR-THE-WIN INSERT	1
	47 ZZUN4677	VERY BURIED INSERT	1
	48ZZUN4798	BALL MAZE PANEL INSERT	1
	49 ZZUN4806	SHIFTING SANDS PANEL INSERT	1
	50 ZZUN8718	PLAYCUBES RETREAT	1
		Audible Activities	
	51 ZZCH4409	ACCESSIBLE BELL PANEL	1
	52ZZCH4649	POST MOUNT DRUM	1
	53ZZPM4467	GROUND TO GROUND BABBLE-ON	1
		Climbers	
	54ZZCH7087	CLIMBING SQUARES BLOCK CLIMBER (36in)	1
	55ZZCH7439	ROCK CLIMBER (48in DECK)	1
	56ZZPM6757	5ft GEO CLIMBER	1
	57ZZPM6836	6ft DECK-DECK VINE CLIMBER	1
	58ZZPM6989	CLIFF HANGER (INCLINED) (72in DECK)	1
	59ZZPM7049	72in TWIST CLIMBER	1
	60ZZPM7086	CLIMBING SQUARES BLOCK CLIMBER (24in)	1
	61ZZPM8338	STEEL CURVE CLIMBER (TRIPPPLE SLIDE)	1
		Stairs and Ladders	
	62ZZCH9168	12in ACCESS STEPPED PLATFORM (DECK TO DECK)	1
	63ZZCH9170	24in ACCESS STEPPED PLATFORM (DECK TO DECK)	1
		Barriers	
	64ZZPM4190	SMALL HAND HOLD	2
	65ZZPM4837	NUVO- ACCESS GATES	4
		Crawl Tubes	
	66ZZPM5190	CRAWL THRU PANEL (GROUND LEVEL)	1
	67ZZPM5698	ADVENTURE CRAWL TUBE FUNNEL (GROUND TO DECK) 2.0	1
		Overhead Events	
	68ZZPM5780	6ft HORIZONTAL LOOP LADDER	1
	69 ZZPM6888	TWIST-N-TWIRL	1
		Bridges	
	70ZZPM6478	CRAZY BONES 6ft x 1ft RISE BRIDGE	1
		Additional Tool & Maintenance Kits	
	71ZZUN1471	INSTALLER HARDWARE KIT	1
	72ZZUN9930	PIPE SYSTEMS MAINTENANCE KIT W/ AEROSOL	1
	73ZZXX0678	LABEL KIT- COMPOSITE STRUCTURE - ASTM	1
	74 ZZXXGNGUIDGENERAL	INSTALLERS GUIDE	1



Downtown Doral Playground

Steel-Footed Post/Installation:

Design Number: PM24392C - Pricing Schedule

2026 Pricing - Valid For : 30 Days From Quote Date

Ref. No.	Part No.	Qty.	Description	Unit Weight (lbs)	Unit List (US\$)	Total Weight (lbs)	Total List (US\$)
Modular Playscape:							
Posts							
	1ZZCH0018		43.5in OD x 124in STEEL POST W/RIVETED CAP	38.9100	324.00	155.64	1,296.00
	2ZZCH0028		43.5in OD x 136in STEEL POST W/ RIVETED CAP	43.5100	330.00	174.04	1,320.00
	3ZZCH0048		43.5in OD x 160in STEEL POST W/ RIVETED CAP	50.2100	370.00	200.84	1,480.00
	4ZZPM0006		75in OD X 96in STEEL POST W/ RIVETED CAP	54.2100	419.00	379.47	2,933.00
	5ZZPM0008		45in OD X 108in STEEL POST W/ RIVETED CAP	60.5100	450.00	242.04	1,800.00
	6ZZPM0016		25in OD X 120in STEEL POST W/ RIVETED CAP	67.1100	478.00	134.22	956.00
	7ZZPM0026		75in OD X 132in STEEL POST W/ RIVETED CAP	74.2100	502.00	519.47	3,514.00
	8ZZPM0036		15in OD X 144in STEEL POST W/ RIVETED CAP	80.9100	545.00	80.91	545.00
	9ZZPM0046		35in OD X 156in STEEL POST W/ RIVETED CAP	87.7100	634.00	263.13	1,902.00
	10ZZPM0056		25in OD X 168in STEEL POST W/ RIVETED CAP	92.5100	659.00	185.02	1,318.00
	11ZZPM0066		55in OD X 180in STEEL POST W/ RIVETED CAP	100.8100	705.00	504.05	3,525.00
Decks & Kick Plates							
	12ZZCH0616		3SQUARE COATED DECK ASSEMBLY	54.8600	1,475.00	164.58	4,425.00
	13ZZPM0617		3TRIANGULAR COATED DECK ASSEMBLY	46.4000	1,357.00	139.20	4,071.00
	14ZZPM0618		11/2 HEX COATED DECK ASSEMBLY	111.8200	2,399.00	111.82	2,399.00
	15ZZPM0619		2HEX COATED DECK ASSEMBLY	228.7200	4,089.00	457.44	8,178.00
	16ZZPM0639		145 DEGREE TRI COATED DECK ASSEMBLY	57.9000	1,093.00	57.90	1,093.00
	17ZZPM2530		112in DECK TO DECK KICK PLATE	11.9500	181.00	11.95	181.00
ADA Items							
	18ZZCH2006	1	TRANSFER STATION (36in DECK)	142.3000	2,222.00	142.30	2,222.00
	19ZZPM7537		1GROUND TO DECK WHEELCHAIR RAMP W/ GUARDRAILS (12in RISE)	388.8400	7,979.00	388.84	7,979.00
	20ZZPM7539		1DECK TO DECK WHEELCHAIR RAMP W/ GUARDRAILS (12in RISE)	379.3000	7,694.00	379.30	7,694.00
	21ZZPM8230		1DECK TO DECK ACCESSIBLE CLIMBER (24in RISE)	321.2000	8,123.00	321.20	8,123.00
	22 ZZUN2019	1	APPROACH STEP FOR TRANSFER STATION	35.8300	574.00	35.83	574.00
	23 ZZUN7369		1RAMP TO BERM CONNECTOR	14.8700	264.00	14.87	264.00
	24 ZZUN9390		16in WHEELCHAIR RAMP CENTER SUPPORT	7.9300	150.00	7.93	150.00
	25 ZZUN9400		118in WHEELCHAIR RAMP CENTER SUPPORT	10.7900	156.00	10.79	156.00
Slides							
	26 ZZCH2696	1	GLIDE SLIDE (72in DECK) GLIDE	151.6300	2,889.00	151.63	2,889.00
	27 ZZCH3126	1	SLIDE (48in DECK) SLIDE- NUVO	119.7300	2,215.00	119.73	2,215.00
	28 ZZCH3537	1	360 SPIRAL SLIDE TRIPPLE	470.7000	7,741.00	470.70	7,741.00
	29 ZZPM1374	1	RACER SLIDE	767.0300	10,414.00	767.03	10,414.00



Downtown Doral Playground

Steel-Footed Post/Installation:

Design Number: PM24392C - Pricing Schedule

2026 Pricing - Valid For : 30 Days From Quote Date

Ref. No.	Part No.	Qty. Description	Unit Weight (lbs)	Unit List (US\$)	Total Weight (lbs)	Total List (US\$)
	30ZZPM3421	1DYNAMIC DESCENT SLIDE - ENTRANCE & EXIT	106.8000	2,444.00	106.80	2,444.00
	31ZZPM3537	1SLIDE- NUVO 360 SPIRAL SLIDE	474.7000	8,163.00	474.70	8,163.00
	32ZZPM8090	1SLIDING POLE (72in DECK)	71.3700	1,548.00	71.37	1,548.00
	33ZZUN3402	4DYNAMIC DESCENT SLIDE - RIGHT TURN SECTION	18.3000	676.00	73.20	2,704.00
	34ZZUN3412	1DYNAMIC DESCENT SUPPORT LEG - 3ft - 6in	17.9000	304.00	17.90	304.00
	Activity Panels					
	35ZZCH4357	1PIPEWALL WITH LOWER TELESCOPE	32.1100	1,027.00	32.11	1,027.00
	20 CH4646	1 STORE FRONT PANEL	33.9800	1,165.00	33.98	1,165.00
	37ZZCH4671	1CH PANEL FRAME- DECK LEVEL	32.8700	537.00	32.87	537.00
	38ZZPM4350	1TIC-TAC-TOE ACTIVITY WALL	59.4000	2,813.00	59.40	2,813.00
	39 ZZPM4356	1 BALCONY	104.2200	2,299.00	104.22	2,299.00
	40ZZPM4407	1ACCESSIBLE SOLAR SYSTEM PANEL	27.6600	1,863.00	27.66	1,863.00
	41ZZPM4408	1ACCESSIBLE BUGS PANEL	42.9600	1,787.00	42.96	1,787.00
	42ZZPM4488	1DRIVE AWAY PANEL (DECK MOUNT)	72.7000	8,086.00	72.70	8,086.00
	43ZZPM4807	1OVAL INSERT PANEL (DECK MOUNT)	39.8200	1,178.00	39.82	1,178.00
	44ZZPM4808	1OVAL INSERT PANEL (GROUND LEVEL)	34.0400	1,213.00	34.04	1,213.00
	45ZZUN4300	1STEERING WHEEL (PIPE WALL MOUNT)	5.3900	247.00	5.39	247.00
	46ZZUN4676	1FOUR-THE-WIN INSERT	15.0800	1,361.00	15.08	1,361.00
	47 ZZUN4677	1 VERY BURIED INSERT	17.9700	2,001.00	17.97	2,001.00
	48ZZUN4798	1BALL MAZE PANEL INSERT	20.4800	884.00	20.48	884.00
	49 ZZUN4806	1 SHIFTING SANDS PANEL INSERT	22.9700	1,261.00	22.97	1,261.00
	50 ZZUN8718	1 PLAYCUBES RETREAT	193.8000	3,639.00	193.80	3,639.00
	Crawl Tubes					
	51ZZPM5190	1CRAWL THRU PANEL (GROUND LEVEL)	34.4600	1,238.00	34.46	1,238.00
	52ZZPM5698	1ADVENTURE CRAWL TUBE FUNNEL (GROUND TO DECK) 2.0	193.8000	4,793.00	193.80	4,793.00
	Barriers					
	53 ZZPM4190	2SMALL HAND HOLD	6.4000	282.00	12.80	564.00
	54 ZZPM4837	4 NUVO- ACCESS GATES	25.8900	1,004.00	103.56	4,016.00
	Climbers					
	55 ZZCH7087	1CLIMBING SQUARES BLOCK CLIMBER (36in)	129.1200	2,556.00	129.12	2,556.00
	56 ZZCH7439	1ROCK CLIMBER (48in DECK)	136.3800	2,586.00	136.38	2,586.00
	57 ZZPM6757	15ft GEO CLIMBER	133.8600	3,223.00	133.86	3,223.00
	58 ZZPM6836	16ft DECK-DECK VINE CLIMBER	314.1300	9,607.00	314.13	9,607.00
	59 ZZPM6989	1 CLIFF HANGER (INCLINED) (72in DECK)	178.5000	3,838.00	178.50	3,838.00
	60 ZZPM7049	172in TWIST CLIMBER	130.2200	3,517.00	130.22	3,517.00



Downtown Doral Playground

Steel-Footed Post/Installation:

Design Number: PM24392C - Pricing Schedule

2026 Pricing - Valid For : 30 Days From Quote Date

Ref. No.	Part No.	Qty.	Description	Unit Weight (lbs)	Unit List (US\$)	Total Weight (lbs)	Total List (US\$)
61ZZPM7086		1	CLIMBING SQUARES BLOCK CLIMBER (24in)	86.3000	1,756.00	86.30	1,756.00
62ZZPM8338		1	STEEL CURVE CLIMBER (TRIPPLE SLIDE)	37.6600	1,016.00	37.66	1,016.00
Overhead Events							
63ZZPM5780		1	16ft HORIZONTAL LOOP LADDER	60.6000	1,135.00	60.60	1,135.00
64 ZZPM6888		1	TWIST-N-TWIRL	51.0700	1,493.00	51.07	1,493.00
Bridges							
65ZZPM6478		1	CRAZY BONES 6ft x 1ft RISE BRIDGE	336.5000	8,767.00	336.50	8,767.00
Audible Activities							
66 ZZCH4409		1	ACCESSIBLE BELL PANEL	22.1600	1,207.00	22.16	1,207.00
67ZZCH4649		1	POST MOUNT DRUM	12.7800	645.00	12.78	645.00
68ZZPM4467		1	GROUND TO GROUND BABBLE-ON	45.4700	1,308.00	45.47	1,308.00
Stairs and Ladders							
69ZZCH9168		1	112in ACCESS STEPPED PLATFORM (DECK TO DECK)	70.2800	1,799.00	70.28	1,799.00
70ZZCH9170		1	124in ACCESS STEPPED PLATFORM (DECK TO DECK)	135.2400	3,438.00	135.24	3,438.00
Additional Tool & Maintenance Kits							
71ZZUN1471		1	INSTALLER HARDWARE KIT	3.9000	0.00	3.90	0.00
72ZZUN9930		1	PIPE SYSTEMS MAINTENANCE KIT W/ AEROSOL	13.0700	0.00	13.07	0.00
73ZZXX0678		1	LABEL KIT- COMPOSITE STRUCTURE - ASTM	0.0400	0.00	0.04	0.00
74 ZZXXGNGUID		1	GENERAL INSTALLERS GUIDE	0.0000	0.00	0.00	0.00
Total:						10,333.19	196,383.00
<u>Independent Items:</u>							
1	ZZXX0260	2	BELT SEAT W/SILVER SHIELD CHAIN FOR 8ft TOP RAIL	8.8000	187.00	17.60	374.00
2	ZZXX0265	2	INFANT SEAT W/SILVER SHIELD FOR 8ft TOP RAIL	11.3100	324.00	22.62	648.00
3	ZZXX0483	1	COZY COCOON - SPINNING	132.0000	4,531.00	132.00	4,531.00
4	ZZXX0635	1	SWING ALONG SEAT TO 8ft TOP RAIL	31.8400	1,371.00	31.84	1,371.00
5	ZZXX0665	1	CONCERTO 5 CONGAS	72.5000	4,819.00	72.50	4,819.00
6	ZZXX0666	1	CONCERTO VIBES	134.8200	6,480.00	134.82	6,480.00
7	ZZXX0667	1	CONCERTO CHIMES	129.3200	6,498.00	129.32	6,498.00
8	ZZXX0888	1	GARDEN SENSORY WALL FOR 1 INSERT	165.6000	2,101.00	165.60	2,101.00
9	ZZXX0892	1	ACCESSIBLE SWING SEAT- 8ft TOP RAIL	53.8000	1,680.00	53.80	1,680.00
10	ZZXX0963	1	15.00in OD 6-UNIT ARCH SWING SHADE (TRIPLE)	2900.6000	21,266.00	2,900.60	21,266.00



Downtown Doral Playground

Steel-Footed Post/Installation:

Design Number: PM24392C - Pricing Schedule

2026 Pricing - Valid For : 30 Days From Quote Date

Ref. No.	Part No.	Qty.	Description	Unit Weight (lbs)	Unit List (US\$)	Total Weight (lbs)	Total List (US\$)
11	ZZXX0966		3ANTI-WRAP ARCH SWING SHADE TOP RAIL	92.1000	1,201.00	276.30	3,603.00
						Total:	3,937.00 53,371.00
						Grand Total:	14,270.19 249,754.00

Please Note:

1. When placing an order for this project, the drawing number is representative of the Playmakers, Challengers or Explorers playstructure only. Items listed under 'Independent Items' must be listed on your purchase order separately to be included.



Downtown Doral Playground

Design Number: PM24392C - Compliance and Technical Data

Reference Document: ASTM F1487

Ref. No.	Part No.	Qty.	Description	Unit ASTM Status	Total Weight (lbs)	Pre-Consumer Recycled (lbs)	Post-Consumer Content (lbs)	CO2e Footprint (kgs)	Users	Install Hours	Concrete (Yds3)	Active Play Events
1	ZZCH0018		43.5in OD x 124in STEEL POST W/RIVETED CAP	Certified	155.64			215	0	4.00	0.50	0
2	ZZCH0028		43.5in OD x 136in STEEL POST W/ RIVETED CAP	Certified	174.04			234	0	4.00	0.50	0
3	ZZCH0048		43.5in OD x 160in STEEL POST W/ RIVETED CAP	Certified	200.84			272	0	4.00	0.50	0
4	ZZCH0616		3SQUARE COATED DECK ASSEMBLY	Certified	164.58			521	9	3.00	0.00	0
5	ZZCH2696	1	GLIDE SLIDE (72in DECK)	Certified	151.63			653	2	1.50	0.03	1
6	ZZCH3126	1	GLIDE SLIDE (48in DECK)	Certified	119.73			492	2	1.50	0.03	1
7	ZZCH3537	1	SLIDE- NUVO 360 SPIRAL SLIDE	Certified	470.70			1,417	2	6.00	0.15	1
8	ZZCH4357		1PIPEWALL WITH LOWER TELESCOPE	Certified	32.11			118	1	0.50	0.00	1
9	ZZCH4409	1	ACCESSIBLE BELL PANEL	Certified	22.16			211	1	0.50	0.00	1
10	ZZCH4646	1	STORE FRONT PANEL	Certified	33.98			243	3	1.00	0.00	1
11	ZZCH4649		1POST MOUNT DRUM	Certified	12.78			167	1	0.50	0.00	1
12	ZZCH4671		1CH PANEL FRAME- DECK LEVEL	Certified	32.87			163	0	1.00	0.00	0
13	ZZCH7087		1CLIMBING SQUARES BLOCK CLIMBER (36in)	Certified	129.12			437	2	4.00	0.12	1
14	ZZCH9168		112in ACCESS STEPPED PLATFORM (DECK TO DECK)	Certified	70.28			277	1	2.00	0.00	0
15	ZZCH9170		124in ACCESS STEPPED PLATFORM (DECK TO DECK)	Certified	135.24			296	1	2.00	0.00	0
16	ZZPM0006		75in OD X 96in STEEL POST W/ RIVETED CAP	Certified	379.47			569	0	7.00	0.91	0
17	ZZPM0008		45in OD X 108in STEEL POST W/ RIVETED CAP	Certified	242.04			361	0	4.00	0.52	0
18	ZZPM0016		25in OD X 120in STEEL POST W/ RIVETED CAP	Certified	134.22			199	0	2.00	0.26	0
19	ZZPM0026		75in OD X 132in STEEL POST W/ RIVETED CAP	Certified	519.47			759	0	7.00	0.84	0
20	ZZPM0036		15in OD X 144in STEEL POST W/ RIVETED CAP	Certified	80.91			117	0	1.00	0.13	0



Downtown Doral Playground

Design Number: PM24392C - Compliance and Technical Data

Reference Document: ASTM F1487

Ref. No.	Part No.	Qty.	Description	Unit ASTM Status	Total Weight (lbs)	Pre-Consumer Recycled Content (lbs)	Post-Consumer Content (lbs)	CO2e Footprint (kgs)	Users	Install Hours	Concrete (Yds3)	Active Play Events
21	ZZPM0046		35in OD X 156in STEEL POST W/ RIVETED CAP	Certified	263.13			379	0	3.00	0.39	0
22	ZZPM0056		25in OD X 168in STEEL POST W/ RIVETED CAP	Certified	185.02			271	0	2.00	0.26	0
23	ZZPM0066		55in OD X 180in STEEL POST W/ RIVETED CAP	Certified	504.05			723	0	5.00	0.65	0
24	ZZPM0617		3TRIANGULAR COATED DECK ASSEMBLY	Certified	139.20			508	6	3.00	0.00	0
25	ZZPM0618		11/2 HEX COATED DECK ASSEMBLY	Certified	111.82			353	5	1.50	0.00	0
26	ZZPM0619		2HEX COATED DECK ASSEMBLY	Certified	457.44			1,275	16	4.00	0.00	0
27	ZZPM0639		145 DEGREE TRI COATED DECK ASSEMBLY	Certified	57.90			206	3	1.00	0.00	0
28	ZZPM1374	1	TRIPPLE RACER SLIDE	Certified	767.03			2,117	6	6.50	0.09	1
29	ZZPM2530	1	12in DECK TO DECK KICK PLATE	Certified	11.95			20	0	0.25	0.00	0
30	ZZPM3421		1DYNAMIC DESCENT SLIDE - ENTRANCE & EXIT	Certified	106.80			358	2	3.50	0.03	1
31	ZZPM3537	1	SLIDE- NUVO 360 SPIRAL SLIDE	Certified	474.70			1,449	2	6.00	0.15	1
32	ZZPM4190		2SMALL HAND HOLD	Certified	12.80			87	0	0.50	0.00	0
33	ZZPM4350		1TIC-TAC-TOE ACTIVITY WALL	Certified	59.40			388	2	0.50	0.00	1
34	ZZPM4356	1	BALCONY	Certified	104.22			290	2	1.00	0.00	1
35	ZZPM4407		1ACCESSIBLE SOLAR SYSTEM PANEL	Certified	27.66			265	1	0.50	0.00	1
36	ZZPM4408	1	ACCESSIBLE BUGS PANEL	Certified	42.96			269	1	1.00	0.00	1
37	ZZPM4467	1	GROUND TO GROUND BABBLE-ON	Certified	45.47			248	2	1.50	0.00	1
38	ZZPM4488		1DRIVE AWAY PANEL (DECK MOUNT)	Certified	72.70			1,455	0	1.50	0.00	0
39	ZZPM4807		1OVAL INSERT PANEL (DECK MOUNT)	Certified	39.82			270	0	0.50	0.00	0
40	ZZPM4808	1	OVAL INSERT PANEL (GROUND LEVEL)	Certified	34.04			275	0	0.50	0.00	0
41	ZZPM4837	4	NUVO- ACCESS GATES	Certified	103.56			831	0	2.00	0.00	0
42	ZZPM5190		1CRAWL THRU PANEL (GROUND LEVEL)	Certified	34.46			279	1	0.50	0.00	1
43	ZZPM5698		1ADVENTURE CRAWL TUBE FUNNEL (GROUND TO DECK) 2.0	Certified	193.80			1,044	4	2.00	0.00	1
44	ZZPM5780	1	6ft HORIZONTAL LOOP LADDER	Certified	60.60			139	2	1.00	0.00	1



Downtown Doral Playground

Design Number: PM24392C - Compliance and Technical Data

Reference Document: ASTM F1487

Ref. No./Part No.	Qty. Description	Unit ASTM Status	Total Weight (lbs)	Pre- Consumer Recycled (lbs)	Post- Consumer Content (lbs)	CO2e Footprint (kgs)	Users	Install Hours	Concrete (Yds3)	Active Play Events
45 ZZPM6478	1 CRAZY BONES 6ft x 1ft RISE BRIDGE	Certified	336.50			2,081	2	4.00	0.00	1
46 ZZPM6757	15ft GEO CLIMBER	Certified	133.86			561	2	2.00	0.09	1
47 ZZPM6836	16ft DECK-DECK VINE CLIMBER	Certified	314.13			1,604	5	3.00	0.09	1
48 ZZPM6888	1 TWIST-N-TWIRL	Certified	51.07			192	1	1.00	0.00	1
49 ZZPM6989	1 CLIFF HANGER (INCLINED) (72in DECK)	Certified	178.50			707	2	2.50	0.06	1
50 ZZPM7049	172in TWIST CLIMBER	Certified	130.22			771	1	1.50	0.03	1
51 ZZPM7086	1CLIMBING SQUARES BLOCK CLIMBER (24in)	Certified	86.30			283	2	3.00	0.09	1
52 ZZPM7537	1GROUND TO DECK WHEELCHAIR RAMP W/ GUARDRAILS (12in RISE)	Certified	388.84			782	4	3.00	0.00	0
53 ZZPM7539	1DECK TO DECK WHEELCHAIR RAMP W/ GUARDRAILS (12in RISE)	Certified	379.30			737	4	3.00	0.00	0
54 ZZPM8090	1 SLIDING POLE (72in DECK)	Certified	71.37			178	1	1.00	0.03	1
55 ZZPM8230	1DECK TO DECK ACCESSIBLE CLIMBER (24in RISE)	Certified	321.20			988	3	1.50	0.00	1
56 ZZPM8338	1STEEL CURVE CLIMBER (TRIPPPLE SLIDE)	Certified	37.66			80	1	1.50	0.06	1
57 ZZUN1471	1INSTALLER HARDWARE KIT	N/A	3.90			57	0	0.00	0.00	0
58 ZZUN2019	1 APPROACH STEP FOR TRANSFER STATION	Certified	35.83			72	1	1.00	0.04	0
59 ZZUN3402	4DYNAMIC DESCENT SLIDE - RIGHT TURN SECTION	Certified	73.20			141	0	2.00	0.00	0
60 ZZUN3412	1DYNAMIC DESCENT SUPPORT LEG - 3ft - 6in	Certified	17.90			45	0	1.50	0.03	0
61 ZZUN4300	1STEERING WHEEL (PIPE WALL MOUNT)	Certified	5.39			28	1	0.25	0.00	1
62 ZZUN4676	1FOUR-THE-WIN INSERT	Certified	15.08			278	2	0.25	0.00	1
63 ZZUN4677	1 VERY BURIED INSERT	Certified	17.97			470	2	0.25	0.00	1
64 ZZUN4798	1BALL MAZE PANEL INSERT	Certified	20.48			121	1	0.50	0.00	1
65 ZZUN4806	1 SHIFTING SANDS PANEL INSERT	Certified	22.97			256	1	0.50	0.00	1
66 ZZUN7369	1RAMP TO BERM CONNECTOR	Certified	14.87			42	0	0.50	0.00	0
67 ZZUN8718	1 PLAYCUBES RETREAT	Certified	193.80			1,022	2	3.00	0.09	1
68 ZZUN9390	16in WHEELCHAIR RAMP CENTER SUPPORT	Certified	7.93			10	0	0.50	0.06	0
69 ZZUN9400	118in WHEELCHAIR RAMP CENTER SUPPORT	Certified	10.79			13	0	0.50	0.06	0



Downtown Doral Playground

Design Number: PM24392C - Compliance and Technical Data

Reference Document: ASTM F1487

Ref. No.	Part No.	Qty.	Description	Unit ASTM Status	Total Weight (lbs)	Pre-Consumer Recycled Content (lbs)	Post-Consumer Recycled Content (lbs)	CO2e Footprint (kgs)	Users	Install Hours	Concrete (Yds3)	Active Play Events
70	ZZXX0260	2	BELT SEAT W/SILVER SHIELD CHAIN FOR 8ft TOP RAIL	Certified	17.60			108	2	0.50	0.00	2
71	ZZXX0265	2	INFANT SEAT W/SILVER SHIELD FOR 8ft TOP RAIL	Certified	22.62			179	2	0.50	0.00	2
72	ZZXX0483	1	COZY COCOON - SPINNING	N/A	132.00			834	3	1.50	0.13	1
73	ZZXX0635	1	SWING ALONG SEAT TO 8ft TOP RAIL	Certified	31.84			341	2	0.50	0.00	1
74	ZZXX0665	1	CONCERTO 5 CONGAS	Certified	72.50			2,497	2	1.00	0.12	1
75	ZZXX0666	1	CONCERTO VIBES	Certified	134.82			3,188	1	2.00	0.26	1
76	ZZXX0678	1	LABEL KIT- COMPOSITE STRUCTURE - ASTM	N/A	0.04			0	0	0.08	0.00	0
77	ZZXX0888	1	GARDEN SENSORY WALL FOR 1 INSERT	N/A	165.60			468	0	1.50	0.12	0
78	ZZXX0892	1	ACCESSIBLE SWING SEAT- 8ft TOP RAIL	N/A	53.80			314	1	0.50	0.00	1
79	ZZXX0963	15.00	in OD 6-UNIT ARCH SWING SHADE (TRIPLE)	N/A	2,900.60			5,934	0	4.00	2.88	0
80	ZZXX0966	3	ANTI-WRAP ARCH SWING SHADE TOP RAIL	N/A	276.30			2	0	6.00	0.00	0
Totals:					13,849.12	2,057	3,936	46,600	131	161.08	10.30	44
					0Kg	0Kg	0Kg	0Metric Tons				0m3



Downtown Doral Playground

Design Number: PM24392C - Compliance and Technical Data

Reference Document: ASTM F1487

Ref. No.	Part No.	Qty.	Description	Unit ASTM Status	Total Weight (lbs)	Pre-Consumer Recycled Content (lbs)	Post-Consumer Content (lbs)	CO2e Footprint (kgs)	Users	Install Hours	Concrete (Yds3)	Active Play Events
----------	----------	------	-------------	------------------	--------------------	-------------------------------------	-----------------------------	----------------------	-------	---------------	-----------------	--------------------

 ASTM F1487

The lay-out for this custom playscape, design number PM24392C, has been configured to meet the requirements of the ASTM F1487 standard. In addition, each of the above components listed as "Certified" have been tested and are IPEMA certified. Components listed as "Not Applicable" do not fall within the scope of the ASTM F1487 standard and have not been tested. IPEMA certification can be verified on the IPEMA website, www.ipema.org. In the interest of playground safety, IPEMA provides a Third Party Certification Service which validates compliance.

 2010 ADA Standards for Accessible Design

The lay-out was also designed to meet the 2010 Standards published 15-Sep-2010, by the Department of Justice when installed over a properly maintained surfacing material that is in compliance with ASTM F1951 "Accessibility of Surface Systems Under and Around Playground Equipment" as well as ASTM F1292, "Impact Attenuation of Surfacing Materials Within the Use Zone of Playground Equipment", appropriate for the fall height of the structure.

 Installation Times

Installation times are based on one experienced installer. A crew of three experienced individuals can perform the installation within the given time, each member working 1/3 of the given hours. [Eg. Installation Time = 30 hours. For a crew of three, each member will work 10 hours on the installation for a total of 30 hours on the project.]

 Carbon Footprint

The CO2e (carbon footprint given in Kilograms and Metric Tons) listed above is a measure of the environmental impact this play structure represents from harvesting raw materials to the time it leaves our shipping dock. Playworld Systems nurtures a total corporate culture that is focused on eliminating carbon producing processes and products, reducing our use of precious raw materials, reusing materials whenever possible and recycling materials at every opportunity. Playworld Systems elected to adopt the Publicly Available Specification; PAS 2050 as published by the British Standards Institute and sponsored by Defra and the Carbon Trust. The PAS 2050 has gained international acceptance as a specification that measures the greenhouse gas emissions in services and goods throughout their entire life cycle.

 Pre-Consumer Recycle Content

A measurement, in pounds, that qualifies the amount of material that was captured as waste and diverted from landfill during an initial manufacturing process and is being redirected to a separate manufacturing process to become a different product. E.g. 100% of our Aluminum Tubing is made from captured waste material during the manufacturing process of extruded Aluminum products such as rods, flat bars and H-channels.

 Post-Consumer Recycle Content

A measurement, in pounds, that qualifies the amount of material that was once another product that has completed its lifecycle and has been diverted from a landfill as a solid waste through recycling and is now being used in a Playworld Systems' product. E.g. **20% to 40% of the steel in our steel tubing and sheet steel have been diverted from landfills. Automobiles are scrapped and recyclable steel is purchased by the steel mill that produces our raw product.

** The amount of Post-Consumer recycled steel fluctuates daily based on the availability of the recycled steel.



Downtown Doral Playground

Design Number: PM24392C - Compliance and Technical Data

Reference Document: CAN/CSA-Z614:20

Ref. No.	Part No.	Qty.	Description	Unit CSA Status	Total Weight (lbs)	Pre-Consumer Recycled Content (lbs)	Post-Consumer Content (lbs)	CO2e Footprint (kgs)	Users	Install Hours	Concrete (Yds3)	Active Play Events
1	ZZCH0018		43.5in OD x 124in STEEL POST W/RIVETED CAP	Certified	155.64			215	0	4.00	0.50	0
2	ZZCH0028		43.5in OD x 136in STEEL POST W/ RIVETED CAP	Certified	174.04			234	0	4.00	0.50	0
3	ZZCH0048		43.5in OD x 160in STEEL POST W/ RIVETED CAP	Certified	200.84			272	0	4.00	0.50	0
4	ZZCH0616		3SQUARE COATED DECK ASSEMBLY	Certified	164.58			521	9	3.00	0.00	0
5	ZZCH2696	1	GLIDE SLIDE (72in DECK)	Certified	151.63			653	2	1.50	0.03	1
6	ZZCH3126	1	GLIDE SLIDE (48in DECK)	Certified	119.73			492	2	1.50	0.03	1
7	ZZCH3537	1	SLIDE- NUVO 360 SPIRAL SLIDE	Certified	470.70			1,417	2	6.00	0.15	1
8	ZZCH4357		1PIPEWALL WITH LOWER TELESCOPE	Certified	32.11			118	1	0.50	0.00	1
9	ZZCH4409	1	ACCESSIBLE BELL PANEL	Certified	22.16			211	1	0.50	0.00	1
10	ZZCH4646	1	STORE FRONT PANEL	Certified	33.98			243	3	1.00	0.00	1
11	ZZCH4649		1POST MOUNT DRUM	Certified	12.78			167	1	0.50	0.00	1
12	ZZCH4671		1CH PANEL FRAME- DECK LEVEL	Certified	32.87			163	0	1.00	0.00	0
13	ZZCH7087		1CLIMBING SQUARES BLOCK CLIMBER (36in)	Certified	129.12			437	2	4.00	0.12	1
14	ZZCH9168		112in ACCESS STEPPED PLATFORM (DECK TO DECK)	Certified	70.28			277	1	2.00	0.00	0
15	ZZCH9170		124in ACCESS STEPPED PLATFORM (DECK TO DECK)	Certified	135.24			296	1	2.00	0.00	0
16	ZZPM0006		75in OD X 96in STEEL POST W/ RIVETED CAP	Certified	379.47			569	0	7.00	0.91	0
17	ZZPM0008		45in OD X 108in STEEL POST W/ RIVETED CAP	Certified	242.04			361	0	4.00	0.52	0
18	ZZPM0016		25in OD X 120in STEEL POST W/ RIVETED CAP	Certified	134.22			199	0	2.00	0.26	0
19	ZZPM0026		75in OD X 132in STEEL POST W/ RIVETED CAP	Certified	519.47			759	0	7.00	0.84	0
20	ZZPM0036		15in OD X 144in STEEL POST W/ RIVETED CAP	Certified	80.91			117	0	1.00	0.13	0



Downtown Doral Playground

Design Number: PM24392C - Compliance and Technical Data

Reference Document: CAN/CSA-Z614:20

Ref. No.	Part No.	Qty.	Description	Unit CSA Status	Total Weight (lbs)	Pre- Consumer Recycled Content (lbs)	Post- Consumer Content (lbs)	CO2e Footprint (kgs)	Users	Install Hours	Concrete (Yds3)	Active Play Events
21	ZZPM0046		35in OD X 156in STEEL POST W/ RIVETED CAP	Certified	263.13			379	0	3.00	0.39	0
22	ZZPM0056		25in OD X 168in STEEL POST W/ RIVETED CAP	Certified	185.02			271	0	2.00	0.26	0
23	ZZPM0066		55in OD X 180in STEEL POST W/ RIVETED CAP	Certified	504.05			723	0	5.00	0.65	0
24	ZZPM0617		3TRIANGULAR COATED DECK ASSEMBLY	Certified	139.20			508	6	3.00	0.00	0
25	ZZPM0618		11/2 HEX COATED DECK ASSEMBLY	Certified	111.82			353	5	1.50	0.00	0
26	ZZPM0619		2HEX COATED DECK ASSEMBLY	Certified	457.44			1,275	16	4.00	0.00	0
27	ZZPM0639		145 DEGREE TRI COATED DECK ASSEMBLY	Certified	57.90			206	3	1.00	0.00	0
28	ZZPM1374	1	TRIPPLE RACER SLIDE	Certified	767.03			2,117	6	6.50	0.09	1
29	ZZPM2530	1	12in DECK TO DECK KICK PLATE	Certified	11.95			20	0	0.25	0.00	0
30	ZZPM3421		1DYNAMIC DESCENT SLIDE - ENTRANCE & EXIT	Certified	106.80			358	2	3.50	0.03	1
31	ZZPM3537	1	SLIDE- NUVO 360 SPIRAL SLIDE	Certified	474.70			1,449	2	6.00	0.15	1
32	ZZPM4190		2SMALL HAND HOLD	Certified	12.80			87	0	0.50	0.00	0
33	ZZPM4350		1TIC-TAC-TOE ACTIVITY WALL	Certified	59.40			388	2	0.50	0.00	1
34	ZZPM4356	1	BALCONY	Certified	104.22			290	2	1.00	0.00	1
35	ZZPM4407		1ACCESSIBLE SOLAR SYSTEM PANEL	Certified	27.66			265	1	0.50	0.00	1
36	ZZPM4408	1	ACCESSIBLE BUGS PANEL	Certified	42.96			269	1	1.00	0.00	1
37	ZZPM4467	1	GROUND TO GROUND BABBLE-ON	Certified	45.47			248	2	1.50	0.00	1
38	ZZPM4488		1DRIVE AWAY PANEL (DECK MOUNT)	Certified	72.70			1,455	0	1.50	0.00	0
39	ZZPM4807		1OVAL INSERT PANEL (DECK MOUNT)	Certified	39.82			270	0	0.50	0.00	0
40	ZZPM4808	1	OVAL INSERT PANEL (GROUND LEVEL)	Certified	34.04			275	0	0.50	0.00	0
41	ZZPM4837	4	NUVO- ACCESS GATES	Certified	103.56			831	0	2.00	0.00	0
42	ZZPM5190		1CRAWL THRU PANEL (GROUND LEVEL)	Certified	34.46			279	1	0.50	0.00	1
43	ZZPM5698		1ADVENTURE CRAWL TUBE FUNNEL (GROUND TO DECK) 2.0	Certified	193.80			1,044	4	2.00	0.00	1
44	ZZPM5780	1	6ft HORIZONTAL LOOP LADDER	Certified	60.60			139	2	1.00	0.00	1



Downtown Doral Playground

Design Number: PM24392C - Compliance and Technical Data

Reference Document: CAN/CSA-Z614:20

Ref. No./Part No.	Qty. Description	Unit CSA Status	Total Weight (lbs)	Pre- Consumer Recycled (lbs)	Post- Consumer Content (lbs)	CO2e Footprint (kgs)	Users	Install Hours	Concrete (Yds3)	Active Play Events
45 ZZPM6478	1 CRAZY BONES 6ft x 1ft RISE BRIDGE	Certified	336.50			2,081	2	4.00	0.00	1
46 ZZPM6757	15ft GEO CLIMBER	Certified	133.86			561	2	2.00	0.09	1
47 ZZPM6836	16ft DECK-DECK VINE CLIMBER	Certified	314.13			1,604	5	3.00	0.09	1
48 ZZPM6888	1 TWIST-N-TWIRL	Certified	51.07			192	1	1.00	0.00	1
49 ZZPM6989	1 CLIFF HANGER (INCLINED) (72in DECK)	Certified	178.50			707	2	2.50	0.06	1
50 ZZPM7049	172in TWIST CLIMBER	Certified	130.22			771	1	1.50	0.03	1
51 ZZPM7086	1CLIMBING SQUARES BLOCK CLIMBER (24in)	Certified	86.30			283	2	3.00	0.09	1
52 ZZPM7537	1GROUND TO DECK WHEELCHAIR RAMP W/ GUARDRAILS (12in RISE)	Certified	388.84			782	4	3.00	0.00	0
53 ZZPM7539	1DECK TO DECK WHEELCHAIR RAMP W/ GUARDRAILS (12in RISE)	Certified	379.30			737	4	3.00	0.00	0
54 ZZPM8090	1 SLIDING POLE (72in DECK)	Certified	71.37			178	1	1.00	0.03	1
55 ZZPM8230	1DECK TO DECK ACCESSIBLE CLIMBER (24in RISE)	Certified	321.20			988	3	1.50	0.00	1
56 ZZPM8338	1STEEL CURVE CLIMBER (TRIPPPLE SLIDE)	Certified	37.66			80	1	1.50	0.06	1
57 ZZUN1471	1INSTALLER HARDWARE KIT	N/A	3.90			57	0	0.00	0.00	0
58 ZZUN2019	1 APPROACH STEP FOR TRANSFER STATION	Certified	35.83			72	1	1.00	0.04	0
59 ZZUN3402	4DYNAMIC DESCENT SLIDE - RIGHT TURN SECTION	Certified	73.20			141	0	2.00	0.00	0
60 ZZUN3412	1DYNAMIC DESCENT SUPPORT LEG - 3ft - 6in	Certified	17.90			45	0	1.50	0.03	0
61 ZZUN4300	1STEERING WHEEL (PIPE WALL MOUNT)	Certified	5.39			28	1	0.25	0.00	1
62 ZZUN4676	1FOUR-THE-WIN INSERT	Certified	15.08			278	2	0.25	0.00	1
63 ZZUN4677	1 VERY BURIED INSERT	Certified	17.97			470	2	0.25	0.00	1
64 ZZUN4798	1BALL MAZE PANEL INSERT	Certified	20.48			121	1	0.50	0.00	1
65 ZZUN4806	1 SHIFTING SANDS PANEL INSERT	Certified	22.97			256	1	0.50	0.00	1
66 ZZUN7369	1RAMP TO BERM CONNECTOR	Certified	14.87			42	0	0.50	0.00	0
67 ZZUN8718	1 PLAYCUBES RETREAT	Certified	193.80			1,022	2	3.00	0.09	1
68 ZZUN9390	16in WHEELCHAIR RAMP CENTER SUPPORT	Certified	7.93			10	0	0.50	0.06	0
69 ZZUN9400	118in WHEELCHAIR RAMP CENTER SUPPORT	Certified	10.79			13	0	0.50	0.06	0



Downtown Doral Playground

Design Number: PM24392C - Compliance and Technical Data

Reference Document: CAN/CSA-Z614:20

Ref. No.	Part No.	Qty.	Description	Unit CSA Status	Total Weight (lbs)	Pre-Consumer Recycled Content (lbs)	Post-Consumer Recycled Content (lbs)	CO2e Footprint (kgs)	Users	Install Hours	Concrete (Yds3)	Active Play Events
70	ZZXX0260	2	BELT SEAT W/SILVER SHIELD CHAIN FOR 8ft TOP RAIL	Certified	17.60			108	2	0.50	0.00	2
71	ZZXX0265	2	INFANT SEAT W/SILVER SHIELD FOR 8ft TOP RAIL	Certified	22.62			179	2	0.50	0.00	2
72	ZZXX0483	1	COZY COCOON - SPINNING	N/A	132.00			834	3	1.50	0.13	1
73	ZZXX0635	1	SWING ALONG SEAT TO 8ft TOP RAIL	Certified	31.84			341	2	0.50	0.00	1
74	ZZXX0665	1	CONCERTO 5 CONGAS	Certified	72.50			2,497	2	1.00	0.12	1
75	ZZXX0666	1	CONCERTO VIBES	Certified	134.82			3,188	1	2.00	0.26	1
76	ZZXX0678	1	LABEL KIT- COMPOSITE STRUCTURE - ASTM	N/A	0.04			0	0	0.08	0.00	0
77	ZZXX0888	1	GARDEN SENSORY WALL FOR 1 INSERT	N/A	165.60			468	0	1.50	0.12	0
78	ZZXX0892	1	ACCESSIBLE SWING SEAT- 8ft TOP RAIL	N/A	53.80			314	1	0.50	0.00	1
79	ZZXX0963	15.00	in OD 6-UNIT ARCH SWING SHADE (TRIPLE)	N/A	2,900.60			5,934	0	4.00	2.88	0
80	ZZXX0966	3	ANTI-WRAP ARCH SWING SHADE TOP RAIL	N/A	276.30			2	0	6.00	0.00	0
Totals:					13,849.12	2,057	3,936	46,600	131	161.08	10.30	44
					0Kg	0Kg	0Kg	0Metric Tons			0m3	



Downtown Doral Playground

Design Number: PM24392C - Compliance and Technical Data

Reference Document: CAN/CSA-Z614:20

Ref. No.	Part No.	Qty.	Description	Unit CSA Status	Total Weight (lbs)	Pre-Consumer Recycled Content (lbs)	Post-Consumer Content (lbs)	CO2e Footprint (kgs)	Users	Install Hours	Concrete (Yds3)	Active Play Events
----------	----------	------	-------------	-----------------	--------------------	-------------------------------------	-----------------------------	----------------------	-------	---------------	-----------------	--------------------

CAN/CSA-Z614:20

The lay-out for this custom playscape, design number PM24392C, has been configured to meet the requirements of the CAN/CSA-Z614:20 standard. In addition, each of the above components listed as "Certified" have been tested and are IPEMA certified. Components listed as "Not Applicable" do not fall within the scope of the CAN/CSA-Z614:20 standard and have not been tested. IPEMA certification can be verified on the IPEMA website, www.ipema.org. In the interest of playground safety, IPEMA provides a Third Party Certification Service which validates compliance.

Installation Times

Installation times are based on one experienced installer. A crew of three experienced individuals can perform the installation within the given time, each member working 1/3 of the given hours. [Eg. Installation Time = 30 hours. For a crew of three, each member will work 10 hours on the installation for a total of 30 hours on the project.]

Carbon Footprint

The CO2e (carbon footprint given in Kilograms and Metric Tons) listed above is a measure of the environmental impact this play structure represents from harvesting raw materials to the time it leaves our shipping dock. Playworld Systems nurtures a total corporate culture that is focused on eliminating carbon producing processes and products, reducing our use of precious raw materials, reusing materials whenever possible and recycling materials at every opportunity. Playworld Systems elected to adopt the Publicly Available Specification; PAS 2050 as published by the British Standards Institute and sponsored by Defra and the Carbon Trust. The PAS 2050 has gained international acceptance as a specification that measures the greenhouse gas emissions in services and goods throughout their entire life cycle.

Pre-Consumer Recycle Content

 A measurement, in pounds, that qualifies the amount of material that was captured as waste and diverted from landfill during an initial manufacturing process and is being redirected to a separate manufacturing process to become a different product. E.g. 100% of our Aluminum Tubing is made from captured waste material during the manufacturing process of extruded Aluminum products such as rods, flat bars and H-channels.

Post-Consumer Recycle Content

 A measurement, in pounds, that qualifies the amount of material that was once another product that has completed its lifecycle and has been diverted from a landfill as a solid waste through recycling and is now being used in a Playworld Systems' product. E.g. **20% to 40% of the steel in our steel tubing and sheet steel have been diverted from landfills. Automobiles are scrapped and recyclable steel is purchased by the steel mill that produces our raw product.

** The amount of Post-Consumer recycled steel fluctuates daily based on the availability of the recycled steel.



Downtown Doral Playground

Design Number: PM24392C - Compliance and Technical Data

Reference Document: EN1176:2008

Ref. No.	Part No.	Qty.	Description	Unit EN Status	Total Weight (lbs)	Pre-Consumer Recycled Content (lbs)	Post-Consumer Content (lbs)	CO2e Footprint (kgs)	Users	Install Hours	Concrete (Yds3)	Active Play Events
1	ZZCH0018		43.5in OD x 124in STEEL POST W/RIVETED CAP	Certified	155.64			215	0	4.00	0.50	0
2	ZZCH0028		43.5in OD x 136in STEEL POST W/ RIVETED CAP	Certified	174.04			234	0	4.00	0.50	0
3	ZZCH0048		43.5in OD x 160in STEEL POST W/ RIVETED CAP	Certified	200.84			272	0	4.00	0.50	0
4	ZZCH0616		3SQUARE COATED DECK ASSEMBLY	Certified	164.58			521	9	3.00	0.00	0
5	ZZCH2696	1	GLIDE SLIDE (72in DECK)	Certified	151.63			653	2	1.50	0.03	1
6	ZZCH3126	1	GLIDE SLIDE (48in DECK)	Certified	119.73			492	2	1.50	0.03	1
7	ZZCH3537	1	SLIDE- NUVO 360 SPIRAL SLIDE	Certified	470.70			1,417	2	6.00	0.15	1
8	ZZCH4357		1PIPEWALL WITH LOWER TELESCOPE	Certified	32.11			118	1	0.50	0.00	1
9	ZZCH4409	1	ACCESSIBLE BELL PANEL	Certified	22.16			211	1	0.50	0.00	1
10	ZZCH4646	1	STORE FRONT PANEL	Certified	33.98			243	3	1.00	0.00	1
11	ZZCH4649		1POST MOUNT DRUM	Certified	12.78			167	1	0.50	0.00	1
12	ZZCH4671		1CH PANEL FRAME- DECK LEVEL	Certified	32.87			163	0	1.00	0.00	0
13	ZZCH7087		1CLIMBING SQUARES BLOCK CLIMBER (36in)	Certified	129.12			437	2	4.00	0.12	1
14	ZZCH9168		112in ACCESS STEPPED PLATFORM (DECK TO DECK)	Certified	70.28			277	1	2.00	0.00	0
15	ZZCH9170		124in ACCESS STEPPED PLATFORM (DECK TO DECK)	Certified	135.24			296	1	2.00	0.00	0
16	ZZPM0006		75in OD X 96in STEEL POST W/ RIVETED CAP	Certified	379.47			569	0	7.00	0.91	0
17	ZZPM0008		45in OD X 108in STEEL POST W/ RIVETED CAP	Certified	242.04			361	0	4.00	0.52	0
18	ZZPM0016		25in OD X 120in STEEL POST W/ RIVETED CAP	Certified	134.22			199	0	2.00	0.26	0
19	ZZPM0026		75in OD X 132in STEEL POST W/ RIVETED CAP	Certified	519.47			759	0	7.00	0.84	0
20	ZZPM0036		15in OD X 144in STEEL POST W/ RIVETED CAP	Certified	80.91			117	0	1.00	0.13	0



Downtown Doral Playground

Design Number: PM24392C - Compliance and Technical Data

Reference Document: EN1176:2008

Ref. No.	Part No.	Qty.	Description	Unit EN Status	Total Weight (lbs)	Pre- Consumer Recycled Content (lbs)	Post- Consumer Content (lbs)	CO2e Footprint (kgs)	Users	Install Hours	Concrete (Yds3)	Active Play Events
21	ZZPM0046		35in OD X 156in STEEL POST W/ RIVETED CAP	Certified	263.13			379	0	3.00	0.39	0
22	ZZPM0056		25in OD X 168in STEEL POST W/ RIVETED CAP	Certified	185.02			271	0	2.00	0.26	0
23	ZZPM0066		55in OD X 180in STEEL POST W/ RIVETED CAP	Certified	504.05			723	0	5.00	0.65	0
24	ZZPM0617		3TRIANGULAR COATED DECK ASSEMBLY	Certified	139.20			508	6	3.00	0.00	0
25	ZZPM0618		11/2 HEX COATED DECK ASSEMBLY	Certified	111.82			353	5	1.50	0.00	0
26	ZZPM0619		2HEX COATED DECK ASSEMBLY	Certified	457.44			1,275	16	4.00	0.00	0
27	ZZPM0639		145 DEGREE TRI COATED DECK ASSEMBLY	Certified	57.90			206	3	1.00	0.00	0
28	ZZPM1374		1 TRIPPLE RACER SLIDE	Certified	767.03			2,117	6	6.50	0.09	1
29	ZZPM2530		1 12in DECK TO DECK KICK PLATE	Certified	11.95			20	0	0.25	0.00	0
30	ZZPM3421		1DYNAMIC DESCENT SLIDE - ENTRANCE & EXIT	Certified	106.80			358	2	3.50	0.03	1
31	ZZPM3537		1 SLIDE- NUVO 360 SPIRAL SLIDE	Certified	474.70			1,449	2	6.00	0.15	1
32	ZZPM4190		2SMALL HAND HOLD	Certified	12.80			87	0	0.50	0.00	0
33	ZZPM4350		1TIC-TAC-TOE ACTIVITY WALL	Certified	59.40			388	2	0.50	0.00	1
34	ZZPM4356		1 BALCONY	Certified	104.22			290	2	1.00	0.00	1
35	ZZPM4407		1ACCESSIBLE SOLAR SYSTEM PANEL	Certified	27.66			265	1	0.50	0.00	1
36	ZZPM4408		1 ACCESSIBLE BUGS PANEL	Certified	42.96			269	1	1.00	0.00	1
37	ZZPM4467		1 GROUND TO GROUND BABBLE-ON	Certified	45.47			248	2	1.50	0.00	1
38	ZZPM4488		1DRIVE AWAY PANEL (DECK MOUNT)	Certified	72.70			1,455	0	1.50	0.00	0
39	ZZPM4807		1OVAL INSERT PANEL (DECK MOUNT)	Certified	39.82			270	0	0.50	0.00	0
40	ZZPM4808		1 OVAL INSERT PANEL (GROUND LEVEL)	Certified	34.04			275	0	0.50	0.00	0
41	ZZPM4837		4 NUVO- ACCESS GATES	Certified	103.56			831	0	2.00	0.00	0
42	ZZPM5190		1CRAWL THRU PANEL (GROUND LEVEL)	Certified	34.46			279	1	0.50	0.00	1
43	ZZPM5698		1ADVENTURE CRAWL TUBE FUNNEL (GROUND TO DECK) 2.0	Certified	193.80			1,044	4	2.00	0.00	1
44	ZZPM5780		1 6ft HORIZONTAL LOOP LADDER	Certified	60.60			139	2	1.00	0.00	1



Downtown Doral Playground

Design Number: PM24392C - Compliance and Technical Data

Reference Document: EN1176:2008

Ref. No./Part No.	Qty. Description	Unit EN Status	Total Weight (lbs)	Pre- Consumer Recycled (lbs)	Post- Consumer Content (lbs)	CO2e Footprint (kgs)	Users	Install Hours	Concrete (Yds3)	Active Play Events
45 ZZPM6478	1 CRAZY BONES 6ft x 1ft RISE BRIDGE	Certified	336.50			2,081	2	4.00	0.00	1
46 ZZPM6757	15ft GEO CLIMBER	Certified	133.86			561	2	2.00	0.09	1
47 ZZPM6836	16ft DECK-DECK VINE CLIMBER	Certified	314.13			1,604	5	3.00	0.09	1
48 ZZPM6888	1 TWIST-N-TWIRL	Certified	51.07			192	1	1.00	0.00	1
49 ZZPM6989	1 CLIFF HANGER (INCLINED) (72in DECK)	Certified	178.50			707	2	2.50	0.06	1
50 ZZPM7049	172in TWIST CLIMBER	Certified	130.22			771	1	1.50	0.03	1
51 ZZPM7086	1CLIMBING SQUARES BLOCK CLIMBER (24in)	Certified	86.30			283	2	3.00	0.09	1
52 ZZPM7537	1GROUND TO DECK WHEELCHAIR RAMP W/ GUARDRAILS (12in RISE)	N/A	388.84			782	4	3.00	0.00	0
53 ZZPM7539	1DECK TO DECK WHEELCHAIR RAMP W/ GUARDRAILS (12in RISE)	N/A	379.30			737	4	3.00	0.00	0
54 ZZPM8090	1 SLIDING POLE (72in DECK)	Certified	71.37			178	1	1.00	0.03	1
55 ZZPM8230	1DECK TO DECK ACCESSIBLE CLIMBER (24in RISE)	Certified	321.20			988	3	1.50	0.00	1
56 ZZPM8338	1STEEL CURVE CLIMBER (TRIPPPLE SLIDE)	Certified	37.66			80	1	1.50	0.06	1
57 ZZUN1471	1INSTALLER HARDWARE KIT	N/A	3.90			57	0	0.00	0.00	0
58 ZZUN2019	1 APPROACH STEP FOR TRANSFER STATION	Certified	35.83			72	1	1.00	0.04	0
59 ZZUN3402	4DYNAMIC DESCENT SLIDE - RIGHT TURN SECTION	Certified	73.20			141	0	2.00	0.00	0
60 ZZUN3412	1DYNAMIC DESCENT SUPPORT LEG - 3ft - 6in	Certified	17.90			45	0	1.50	0.03	0
61 ZZUN4300	1STEERING WHEEL (PIPE WALL MOUNT)	Certified	5.39			28	1	0.25	0.00	1
62 ZZUN4676	1FOUR-THE-WIN INSERT	Certified	15.08			278	2	0.25	0.00	1
63 ZZUN4677	1 VERY BURIED INSERT	Certified	17.97			470	2	0.25	0.00	1
64 ZZUN4798	1BALL MAZE PANEL INSERT	Certified	20.48			121	1	0.50	0.00	1
65 ZZUN4806	1 SHIFTING SANDS PANEL INSERT	Certified	22.97			256	1	0.50	0.00	1
66 ZZUN7369	1RAMP TO BERM CONNECTOR	N/A	14.87			42	0	0.50	0.00	0
67 ZZUN8718	1 PLAYCUBES RETREAT	Certified	193.80			1,022	2	3.00	0.09	1
68 ZZUN9390	16in WHEELCHAIR RAMP CENTER SUPPORT	Certified	7.93			10	0	0.50	0.06	0
69 ZZUN9400	118in WHEELCHAIR RAMP CENTER SUPPORT	Certified	10.79			13	0	0.50	0.06	0



Downtown Doral Playground

Design Number: PM24392C - Compliance and Technical Data

Reference Document: EN1176:2008

Ref. No.	Part No.	Qty. Description	Unit EN Status	Total Weight (lbs)	Pre-Consumer Recycled Content (lbs)	Post-Consumer Content (lbs)	CO2e Footprint (kgs)	Users	Install Hours	Concrete (Yds3)	Active Play Events
70	ZZXX0260	2BELT SEAT W/SILVER SHIELD CHAIN FOR 8ft TOP RAIL	N/A	17.60			108	2	0.50	0.00	2
71	ZZXX0265	2INFANT SEAT W/SILVER SHIELD FOR 8ft TOP RAIL	N/A	22.62			179	2	0.50	0.00	2
72	ZZXX0483	1 COZY COCOON - SPINNING	N/A	132.00			834	3	1.50	0.13	1
73	ZZXX0635	1SWING ALONG SEAT TO 8ft TOP RAIL	N/A	31.84			341	2	0.50	0.00	1
74	ZZXX0665	1 CONCERTO 5 CONGAS	Certified	72.50			2,497	2	1.00	0.12	1
75	ZZXX0666	1 CONCERTO VIBES	Certified	134.82			3,188	1	2.00	0.26	1
76	ZZXX0678	1LABEL KIT- COMPOSITE STRUCTURE - ASTM	N/A	0.04			0	0	0.08	0.00	0
77	ZZXX0888	1GARDEN SENSORY WALL FOR 1 INSERT	N/A	165.60			468	0	1.50	0.12	0
78	ZZXX0892	1ACCESSIBLE SWING SEAT- 8ft TOP RAIL	N/A	53.80			314	1	0.50	0.00	1
79	ZZXX0963	15.00in OD 6-UNIT ARCH SWING SHADE (TRIPLE)	N/A	2,900.60			5,934	0	4.00	2.88	0
80	ZZXX0966	3ANTI-WRAP ARCH SWING SHADE TOP RAIL	N/A	276.30			2	0	6.00	0.00	0
Totals:				13,849.12	2,057	3,936	46,600	131	161.08	10.30	44
				0Kg	0Kg	0Kg	0Metric Tons			0m3	



Downtown Doral Playground

Design Number: PM24392C - Compliance and Technical Data

Reference Document: EN1176:2008

Ref. No.	Part No.	Qty.	Description	Unit EN Status	Total Weight (lbs)	Pre-Consumer Recycled Content (lbs)	Post-Consumer Content (lbs)	CO2e Footprint (kgs)	Users	Install Hours	Concrete (Yds3)	Active Play Events
----------	----------	------	-------------	----------------	--------------------	-------------------------------------	-----------------------------	----------------------	-------	---------------	-----------------	--------------------

EN1176:2008

This custom structure, drawing number PM24392C, has been designed to meet the general safety requirements of EN1176:2008. These requirements have been established with the consideration of the risk factor on available data. The items listed as certified have been reviewed and approved by a third party certification service. In addition to the product listing the overall layout and design of this structure, as shown in the plan, was completed in accordance with the general safety requirements of EN1176:2008.

Installation Times

Installation times are based on one experienced installer. A crew of three experienced individuals can perform the installation within the given time, each member working 1/3 of the given hours. [Eg. Installation Time = 30 hours. For a crew of three, each member will work 10 hours on the installation for a total of 30 hours on the project.]

Carbon Footprint

The CO2e (carbon footprint given in Kilograms and Metric Tons) listed above is a measure of the environmental impact this play structure represents from harvesting raw materials to the time it leaves our shipping dock. Playworld Systems nurtures a total corporate culture that is focused on eliminating carbon producing processes and products, reducing our use of precious raw materials, reusing materials whenever possible and recycling materials at every opportunity. Playworld Systems elected to adopt the Publicly Available Specification; PAS 2050 as published by the British Standards Institute and sponsored by Defra and the Carbon Trust. The PAS 2050 has gained international acceptance as a specification that measures the greenhouse gas emissions in services and goods throughout their entire life cycle.

Pre-Consumer Recycle Content

A measurement, in pounds, that qualifies the amount of material that was captured as waste and diverted from landfill during an initial manufacturing process and is being redirected to a separate manufacturing process to become a different product. E.g. 100% of our Aluminum Tubing is made from captured waste material during the manufacturing process of extruded Aluminum products such as rods, flat bars and H-channels.

Post-Consumer Recycle Content

A measurement, in pounds, that qualifies the amount of material that was once another product that has completed its lifecycle and has been diverted from a landfill as a solid waste through recycling and is now being used in a Playworld Systems' product. E.g. **20% to 40% of the steel in our steel tubing and sheet steel have been diverted from landfills. Automobiles are scrapped and recyclable steel is purchased by the steel mill that produces our raw product.

** The amount of Post-Consumer recycled steel fluctuates daily based on the availability of the recycled steel.

